

TECHNICAL MANUAL

ORGANIZATIONAL, DIRECT SUPPORT, AND GENERAL SUPPORT

MAINTENANCE REPAIR PARTS AND SPECIAL TOOLS LISTS

(INCLUDING DEPOT MAINTENANCE REPAIR PARTS AND SPECIAL TOOLS)

FOR

TEST SET, ANTENNA AN/ARM-115

(NSN 6625-00-935-4293)

HEADQUARTERS, DEPARTMENT OF THE ARMY

NOVEMBER 1978

TM 11-6625-1702-24P

TECHNICAL MANUAL

ORGANIZATIONAL, DIRECT SUPPORT, AND GENERAL SUPPORT

MAINTENANCE REPAIR PARTS AND SPECIAL TOOLS LISTS

(INCLUDING DEPOT MAINTENANCE REPAIR PARTS AND SPECIAL TOOLS)

FOR

TEST SET, ANTENNA AN/ARM-115

(NSN 6625-00-935-4293)

HEADQUARTERS, DEPARTMENT OF THE ARMY

NOVEMBER 1978

TM 11-6625-1702-24P

TECHNICAL MANUAL

**ORGANIZATIONAL, DIRECT SUPPORT, AND GENERAL SUPPORT
MAINTENANCE REPAIR PARTS AND SPECIAL TOOLS LISTS
INCLUDING DEPOT MAINTENANCE REPAIR PARTS AND SPECIAL TOOLS)
FOR**

**TEST SET, ANTENNA AN/ARM-115
(NSN 6625-00-935-4293)**

HEADQUARTERS, DEPARTMENT OF THE ARMY

NOVEMBER 1978

TECHNICAL MANUAL }
 No. 11-6625-1702-24P }

HEADQUARTERS
 DEPARTMENT OF THE ARMY
 Washington, DC, 1 November 1978

**ORGANIZATIONAL DIRECT SUPPORT, AND
 GENERAL SUPPORT MAINTENANCE REPAIR PARTS AND SPECIAL TOOLS LISTS
 (INCLUDING DEPOT MAINTENANCE REPAIR PARTS AND SPECIAL TOOLS)**

**TEST SET, ANTENNA AN/ARM-115
 (NSN 6625-00-935-4293)**

Current as of 23 June 1978

REPORTING OF ERRORS

You can improve this manual by recommending improvements using DA Form 2028-2 located in the back of the manual. Simply tear out the self-addressed form, fill it out as shown on the sample, fold it where shown, and drop it in the mail.

If there are no blank DA Form 2028-2 in the back of your manual, use the standard DA Form 2028 (Recommended Changes to Publications and Blank Forms) and forward to the Commander, US Army Communications and Electronics Materiel Readiness Command, ATTN: DRSEL-ME-MQ, Fort Monmouth, New Jersey 07703.

In either case a reply will be furnished direct to you.

Table of Contents

SECTION		Page	Illus Figure
	I. Introduction	1	
	II. Repair parts list.....	5	
Group	00 Test Set, Antenna AN/ARM-115	5	1
	01 Case, Test Set CY-6149/ARM-115 (no parts authorized)		
	02 Test Set, Antenna TS-2642/ARM-115.....	7	2,3
	0201 Circuit card assembly.....	10	4
	03 Radome CW-927/ARM-115 (No parts authorized)		
	04 Ground Plane Assembly MX-8000/ARM-115 (No parts authorized)		
	05 Cable, power (red) 785-4933-001.....	11	5
	06 Cable, power (black) 785-4933-002.....	12	6
	07 Test lead (red) 785-4935-001	13	7
	08 Test lead (black) 785-4935-002	14	8
	09 Cable CX-10776/ARM-115	15	9
	10 Cable CG-1893A/U	16	10
	III. Special tools list (Not applicable)		
	IV. National Stock number and part number index.....	17	

*This manual supersedes TM 11-6625-1702-24P, 29 April 1977.

SECTION I INTRODUCTION

1. Scope

This manual lists spares and repair parts; special tools special test, measurement, and diagnostic equipment (TMDE), and other special support equipment required for performance of organizational, direct support, and general support maintenance of the AN/ARM-115. It authorizes the requisitioning and issue of spares and repair parts as indicated by the source and maintenance codes.

2. General

This Repair Parts and Special Tools List is divided into the following sections

a. Section II. Repair Parts List. A list of spares and repair parts authorized for use in the performance of maintenance. The list also includes parts which must be removed for replacement of the authorized parts. Parts lists are composed of functional groups in numeric sequence, with the parts in each group listed in figure and item number sequence.

b. Section III. Special Tools List. Not applicable.

c. Section IV. National Stock Number and Part Number Index. A list, in National item identification number (NIIN) sequence, of all National stock numbers (NSN) appearing in the listings, followed by a list, in alphabetic sequence, of all part numbers appearing in the listings. National stock numbers and part numbers are cross-referenced to each illustration figure and item number appearance.

3. Explanation of Columns

a. Illustration. This column is divided as follows

(1) *Figure number.* Indicates the figure number of the illustration on which the item is shown.

(2) *Item number.* The number used to identify item called out in the illustration.

b. Source, Maintenance, and Recoverability (SMR) Codes

(1) *Source code.* Source codes indicate the manner of acquiring support items for maintenance, repair, or overhaul of end items. Source codes are entered in the first and second positions of the Uniform SMR Code format as follows:

Code	Definition
PA	Item procured and stocked for anticipated or known usage.

XD—A support item that is not stocked. When required, item will be procured through normal supply channels.

NOTE

Cannibalization or salvage maybe used as a source of supply for any items source coded above except those coded XA and aircraft support items as restricted by AR 700-42.

(2) *Maintenance code.* Maintenance codes are assigned to indicate the levels of maintenance authorized to USE and REPAIR support items. The maintenance codes are entered in the third and fourth positions of the Uniform SMR Code format as follows:

(a) The maintenance code entered in the third position will indicate the lowest maintenance level authorized to remove, replace, and use the support item. The maintenance code entered in the third position will indicate one of the following levels of maintenance

Code	Application/Explanation
0	-Support item is removed, replaced, used at the organisational level.
F	-Support item is removed, replaced, used at the direct support level.
H	-Support item is removed, replaced, used at the general support level.

(b) The maintenance code entered in the fourth position indicates whether the item is to be repaired and identifies the lowest maintenance level with the capability to perform complete repair (i.e., all authorized maintenance functions). This position will contain one of the following maintenance codes:

Code	Application/Explanation
O	—The lowest maintenance level capable of complete repair of the support item is the organizational level.
F	—The lowest maintenance level capable of complete repair of the support item is the direct support level.
Z	—Nonreparable. No repair is authorized.

(3) *Recoverability code.* Recoverability codes are assigned to support items to indicate the disposition action on unserviceable items. The recoverability code is entered in the fifth position of the Uniform SMR Code format as follows:

Recoverability Codes	Definition
Z	—Nonreparable item. When unserviceable, condemn and dispose at the level indicated in position 3.
O	—Reparable item. When uneconomically repairable, condemn and dispose at organizational level.
F	—Reparable item. When uneconomically repairable, condemn and dispose at the direct support level.

c. National Stock Number. Indicates the National stock number assigned to the item and will be used for requisitioning purposes.

d. Part Number. Indicates the primary number used by the manufacturer (individual, company, firm, cor-

poration, or Government activity), which controls the design and characteristics of the item by means of its engineering drawings, specifications, standards, and inspection requirements to identify an item or range of items.

NOTE

When a stock numbered item is requisitioned, the repair part received may have a different part number than the part being replaced.

e. Federal Supply Code for Manufacturer (FSCM). The FSCM is a 5-digit numeric code listed in SB 708-42 which is used to identify the manufacturer, distributor, or Government agency, etc.

f. Description. Indicates the Federal item name and, if required, a minimum description to identify the item.

g. Unit of Measure (U/M). Indicates the standard of the basic quantity of the listed item as used in performing the actual maintenance function. This measure is expressed by a two-character alphabetical abbreviation (e.g., es, in, pr, etc). When the unit of measure differs from the unit of issue, the lowest unit of issue that will satisfy the required units of measure will be requisitioned.

h. Quantity Incorporated in Unit. Indicates the quantity of the item used in the breakout shown on the illustration figure, which is prepared for a functional group, subfunctional group, or an assembly.

4. Special Information

The following publication pertains to the AN/ARM-115 and its components
TM 11-6625-1702-12, Test Set, Antenna AN/ARM-115

TM 11-6625-1702-35, Test Set, Antenna AN/ARM-115

5. How to Locate Repair Parts

a. When National stock number or part number is unknown.

(1) *First.* Using the table of contents, determine the functional group within which the item belongs. This is necessary since illustrations are prepared for functional groups and listings are divided into the same groups.

(2) *Second.* Find the illustration covering the functional group to which the item belongs.

(3) *Third.* Identify the item on the illustration and note the illustration figure and item number of the item.

(4) *Fourth.* Using the Repair Parts Listing, find the figure and item number noted on the illustration.

b. When National stock number or part number is known.

(1) *First.* Using the Index of National Stock Numbers and Part Numbers, find the pertinent National stock number or part number. This index is in NIIN sequence followed by a list of part numbers in alphameric sequence, cross-referenced to the illustration figure number and item number.

(2) *Second.* After finding the figure and item number, locate the figure and item number in the repair parts list.

6. Abbreviations

Not Applicable.

(Next printed page is 5)

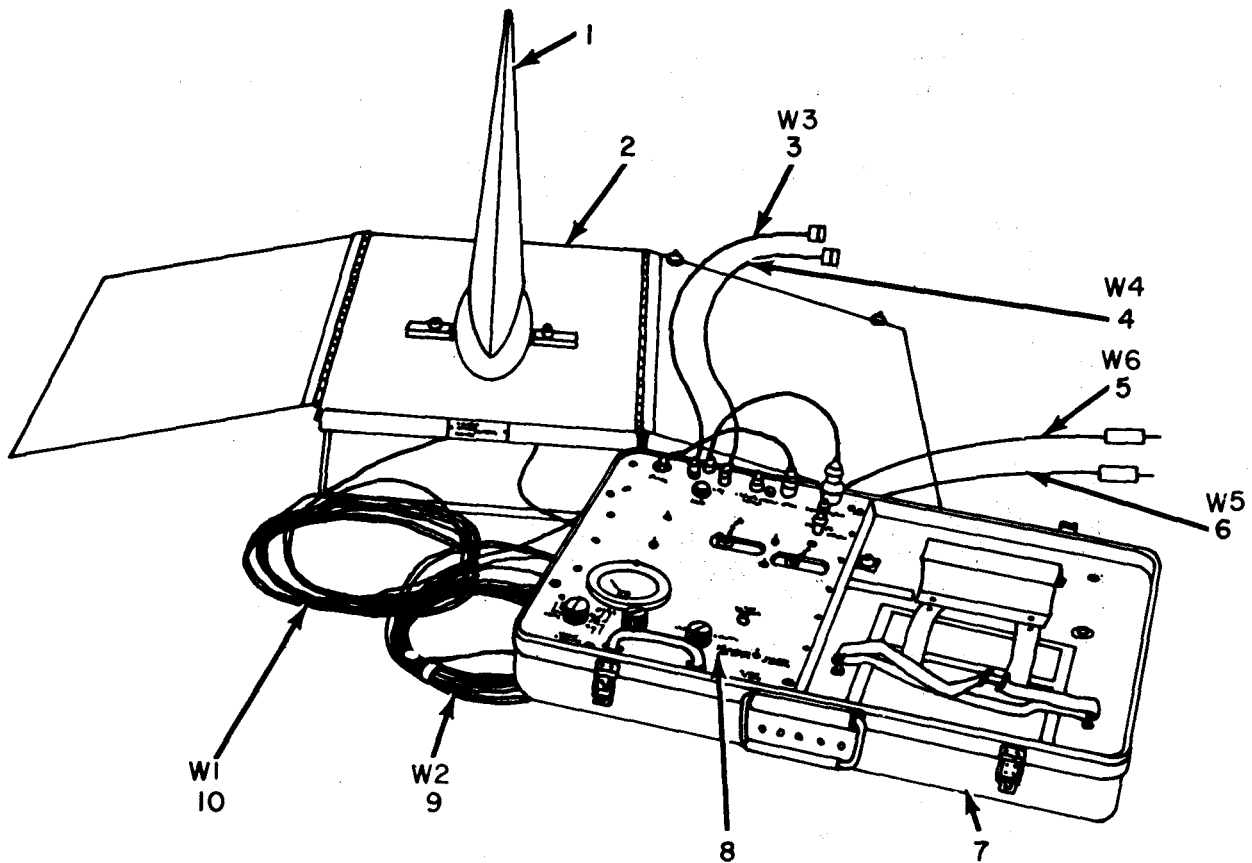

EL2VK001

Figure 1. Test Set, Antenna AN/ARM-115.

(1) ILLUSTRATION		(2)	(3)	(4)	(5)	(6) DESCRIPTION	(7)	(8)
(a) FIG NO.	(b) ITEM NO.	SMR CODE	NATIONAL STOCK NUMBER	PART NUMBER	FSCM	USABLE ON CODE	U/M	QTY INC IN UNIT
						GROUP 00 TEST SET, ANTENNA AN/ARM-115		
1	1	PAOZZ	6625-00-935-4903	CN972ARM115	80058	RADOME	EA	1
1	2	PAOZZ	6625-00-878-4582	MX8000ARM115	80058	GROUND PLANE ASS EMBLY	EA	1
1	3	PAO00	6625-00-782-0823	785-4933-001	13499	CABLE, POWER SOURCE (RED)	EA	
1	4	PAO00	6625-00-782-0824	785-4933-002	13499	CABLE, POWER SOURCE (BLACK)	EA	
1	5	PAO00	6625-00-782-0835	785-4935-001	13499	CABLE, TEST PCS ITIVE	EA	
1	6	PAO00	6625-00-782-0822	765-4935-002	13499	CABLE, TEST NEGATIVE	EA	
1	7	PAHZZ	6625-00-935-4298	CY6419ARM115	80058	CASE, TEST SET	EA	
1	8	PAFFF	6625-00-935-4297	TS2642ARM115	80058	TEST SET, ANTENNA, TS2642ARM115	EA	
1	9	PAO00	5995-00-935-2671	CG1893AU	80058	CABLE ASSEMBLY, SPECIAL PURPOSE, CG1893AU	EA	1
1	10	PAO00	6625-00-935-2678	CX10776ARM115	80058	CABLE ASSEMBLY, SPECIAL PURPOSE, CX10776ARM115	EA	1

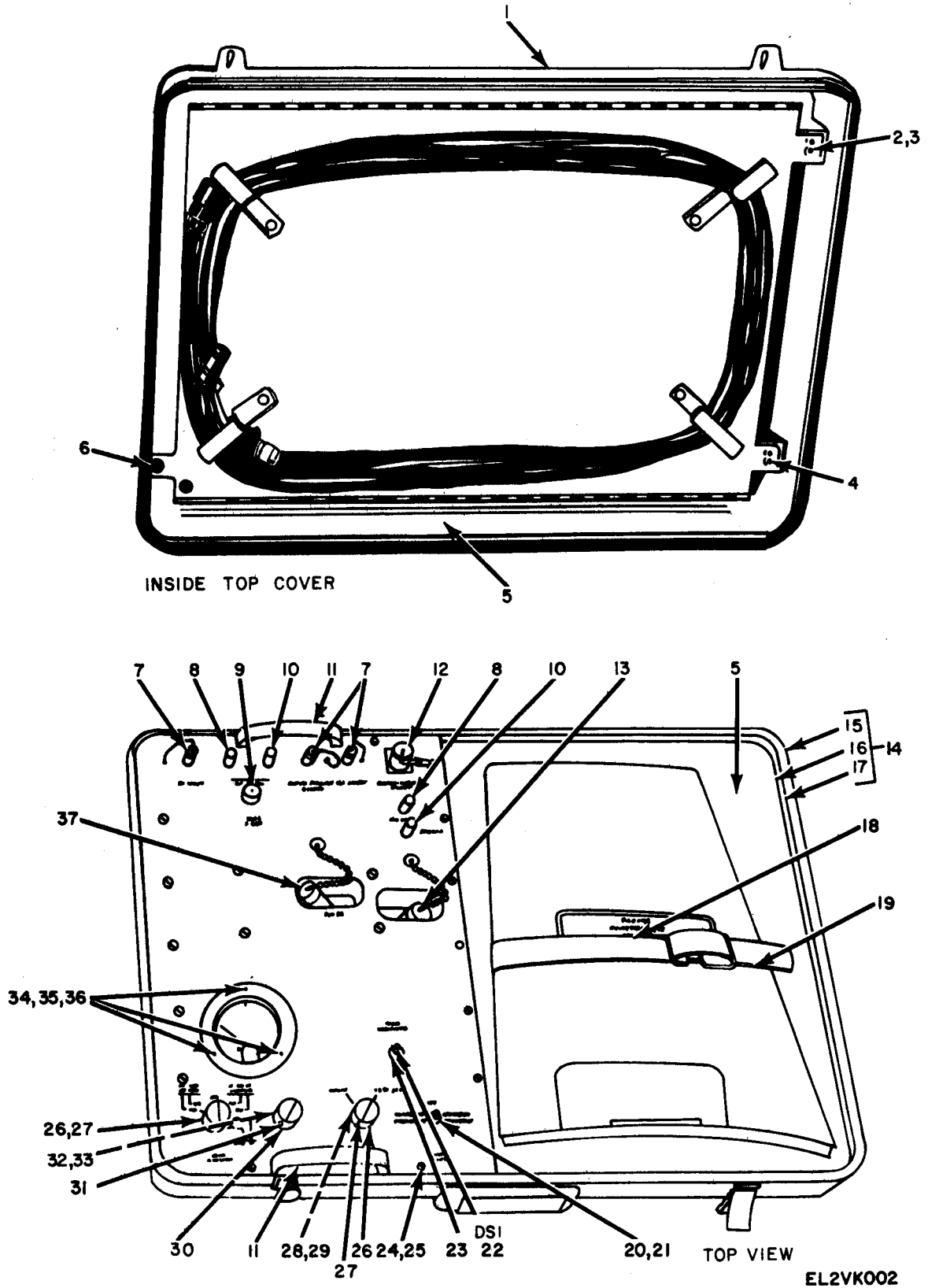
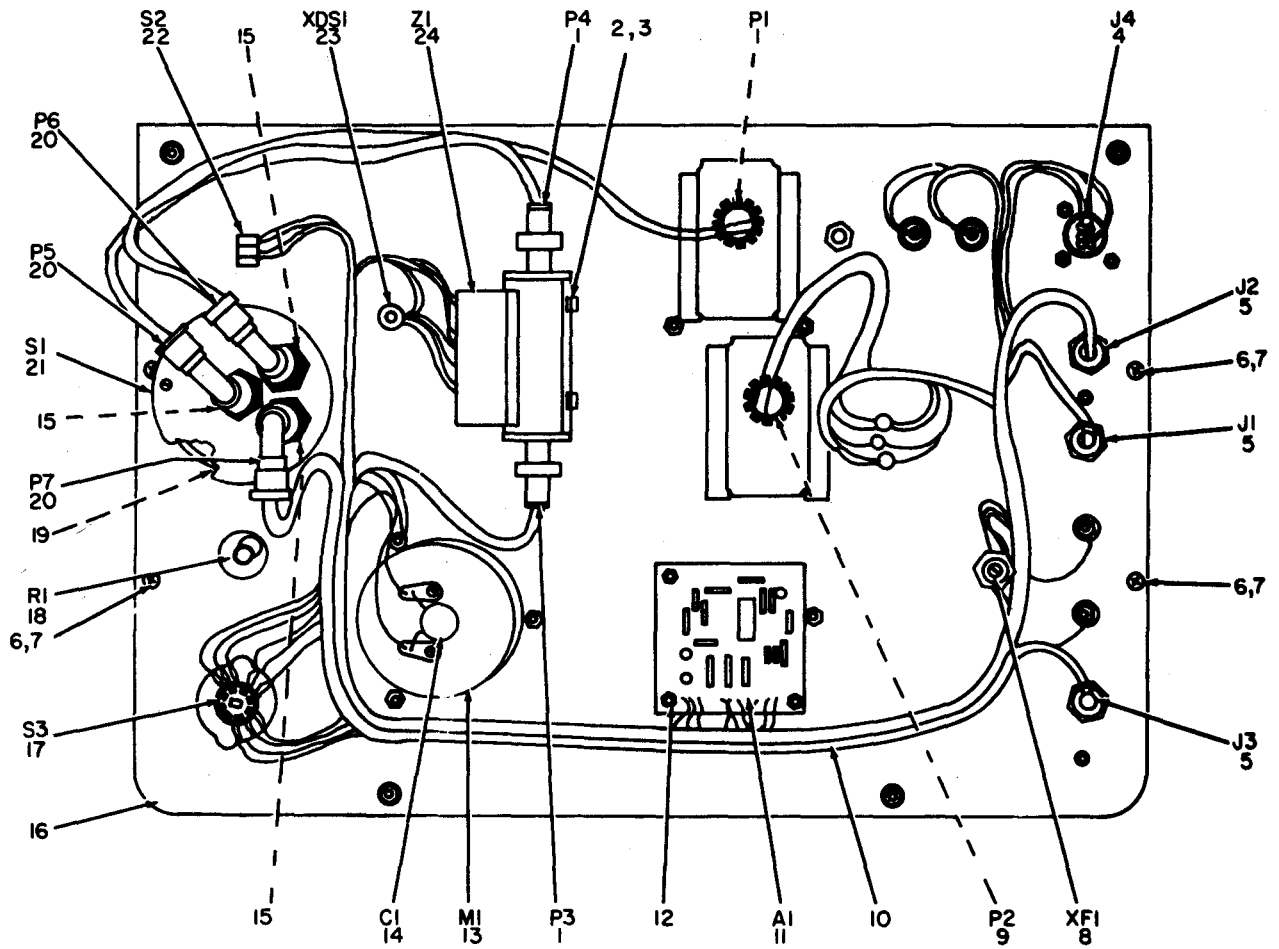

Figure 2. Test Set, Antenna TS-2642/ARM-115.

SECTION II (1) ILLUSTRATION (A) (B) FIG ITEM NO NO		(2) SMR CODE	(3) NATIONAL STOCK NUMBER	(4) PART NUMBER	(5) FSCM	TM11-6625-1702-24P (6) DESCRIPTION	(7) USABLE ON CODE U/M	(8) QTY INC IN UNIT
						GROUP 02 TEST SET, ANTENNA TS-2642/ARM-115		
2	1	XDFZZ	6625-00-935-4296	CW973ARM115	80058	COVER, TEST SET	EA	1
2	2	XDFZZ		783-4126-001	13499	MOUNT, ANTENNA BOTTOM	EA	1
2	3	XDFZZ	5310-00-685-1450	310-0049-00	79807	WASHER, FLAT	EA	1
2	4	XDFZZ		783-4126-002	13499	MOUNT, ANTENNA BOTTOM	EA	1
2	5	XDFZZ		SKS1800	74284	SHELL, COVER	EA	2
2	6	XDFZZ		783-4130-001	13499	MOUNT, ANTENNA TOP	EA	1
2	7	XDFZZ		CW123AU	80056	COVER, CONNECTOR	EA	3
2	8	PAFZZ	5940-00-817-4880	29-1R	81073	POST, BINDING	EA	2
2	9	PAOZZ	5920-00-855-4260	F02B125V2AS	81349	FUSE, CARTRIDGE	EA	1
2	10	PAFZZ	5940-00-577-3695	29-1B	81073	POST, BINDING	EA	2
2	11	XDFZZ		729	01016	HANDLE, BOW	EA	2
2	12	PAFZZ	5935-00-904-4469	MS3181-12C	96906	COVER, CONNECTOR	EA	1
2	13	PAFZZ	5935-00-946-2091	MS3180-12C	96906	COVER, CONNECTOR	EA	1
2	14	XDFZZ		SKS1789	74284	EDGE, FRAME ASSEMBLY	EA	1
2	15	XDFZZ		SKM397	74284	EDGE, FEMALE	EA	1
2	16	XDFZZ		SKM598	74284	EDGE, MALE	EA	1
2	17	XDFZZ		SKM518	74284	GASKET, TUBULAR	EA	1
2	18	XDFZZ		011-0113-00	24036	STRAP, HOLD DOWN	EA	1
2	19	XDFZZ		011-0115-00	24036	STRAP, HOLD DOWN	EA	1
2	20	PAFZZ	5310-00-924-5968	MS25081-1	96906	WASHER, KEYWAY	EA	1
2	21	XDFZZ	5310-00-269-6291	8947-151	04009	NUT, PLAIN, HEXAGON	EA	2
2	22	PAOZZ	6240-00-080-2012	327AS15	71744	LAMP, INCANDESCENT	EA	1
2	23	XDFZZ		MS25082-8	96906	NUT, PLAIN, HEXAGON	EA	1
2	24	XDFZZ	5305-00-763-6961	MS51959-26	96906	SCREW, MACHINE	EA	24
2	25	PAFZZ	5310-00-933-8118	MS35338-135	96906	WASHER, LOCK	EA	18
2	26	PAOZZ	5355-00-253-4199	757-0228-003	13499	KNOB, PLASTIC	EA	2
2	27	XDOZZ		MS51981-28	96906	SETSCREW	EA	2
2	28	XDOZZ		8000-26	00471	NUT, PLAIN, HEXAGON	EA	1
2	29	XDOZZ		1005-3	00471	WASHER, LOCK	EA	1
2	30	PAOZZ	5355-00-909-0465	757-0228-001	13499	KNOB, PLASTIC	EA	1
2	31	XDOZZ		MS51981-26	96906	SETSCREW	EA	4
2	32	XDOZZ		P313-0064-00	77250	NUT, PLAIN, HEXAGON	EA	2
2	33	XDOZZ	5310-00-261-7717	1720-02	78189	WASHER, LOCK	EA	2
2	34	XDFZZ		68NM62	72962	NUT, SELF-LOCKING, HEXAGON	EA	3
2	35	XDFZZ	5305-00-054-6653	MS51957-29	96906	SCREW, MACHINE	EA	3
2	36	XDFZZ	5310-00-550-3796	1718-02	78189	WASHER, LOCK	EA	3
2	37	XDFZZ		BNCCC2F3	71468	COVER, CONNECTOR	EA	1



EL2VK003

Figure 3. Test Set, Antenna TS-2642/ARM-115 (Rear View).

SECTION II (1) ILLUSTRATION (A) (B) FIG ITEM NO NO		(2) SMR CODE	(3) NATIONAL STOCK NUMBER	(4) PART NUMBER	(5) FSCM	TM11-6625-1702-24P (6) DESCRIPTION	(7) USABLE ON CODE U/M	(8) QTY INC IN UNIT
3	1	PAFZZ	5935-00-823-0487	UG88EU	80058	CONNECTOR, PLUG, ELECTRICAL	EA	3
3	2	XDFZZ	5305-00-054-6651	MS51957-27	96906	SCREW, MACHINE	EA	4
3	3	XDFZZ	5310-00-929-6395	MS35338-136	96906	WASHER, LOCK	EA	4
3	4	PAFZZ	5935-00-826-1020	MS112E12-105	96906	CONNECTOR, RECEPTACLE	EA	1
3	5	PAFZZ	5935-00-850-8876	UG909CU	80058	CONNECTOR, RECEPTACLE	EA	3
3	6	XDFZZ	5305-00-050-9228	MS51957-62	96906	SCREW, MACHINE	EA	4
3	7	XDFZZ	5310-00-933-8120	MS35338-138	96906	WASHER, LOCK	EA	4
3	8	PAFZZ	5920-00-892-9311	FHN26G	81349	FUSEHOLDER	EA	1
3	9	PAFZZ	5935-00-729-8688	PT06A12-10SSR	77820	CONNECTOR, PLUG, ELECTRICAL	EA	1
3	10	XDFZZ		1ASWTE730AJTEO	90484	CABLE, SPEICAL PURPOSE	EA	1
3	11	PAFFF	6625-00-498-2492	774-7389-001	13499	CIRCUIT CARD ASSEMBLY	EA	1
3	12	XDFZZ		768-3176-004	13499	INSERT	EA	4
3	13	PAFZZ	6625-00-782-0369	2531-5101002SPL	65092	AMMETER, DIRECT CURRENT	EA	1
3	14	PAFZZ	5910-00-822-5683	CK63AW103M	81349	CAPACITOR, FIXED, CERAMIC DISK	EA	1
3	15	XDFZZ		60-31	00471	CONNECTOR, RECEPTACLE	EA	3
3	16	XDFZZ		766-7635-002	13499	PANEL	EA	1
3	17	XDFZZ		228001K3	76854	SWITCH, ROTARY	EA	1
3	18	PAFZZ	5905-00-057-8496	KS22959	71450	RESISTOR, VARIABLE	EA	1
3	19	XDFZZ		8100-18	00471	PLATE, ESCUTHEON	EA	1
3	20	PAFZZ	5935-00-682-0501	MS35367-913A	96906	CONNECTOR, PLUG, ELECTRICAL	EA	3
3	21	XDFZZ		78-28NC	00471	SWITCH, RADIO FREQUENEY	EA	1
3	22	PAFZZ	5930-00-655-1518	MS35058-27	81349	SWITCH, TOGGLE	EA	1
3	23	PAFZZ	6210-00-682-9833	MS25256-6	96906	INDICATOR LIGHT	EA	1
3	24	PAFZZ	6625-00-782-0367	4152C	70998	DETECTING ELEMENT, COUPLER	EA	1

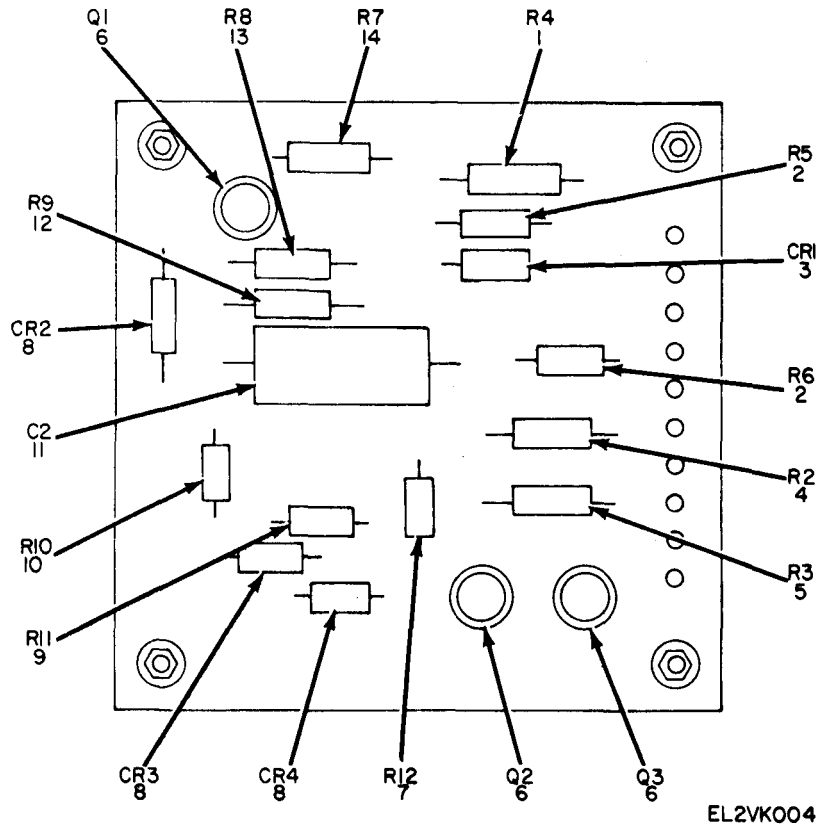
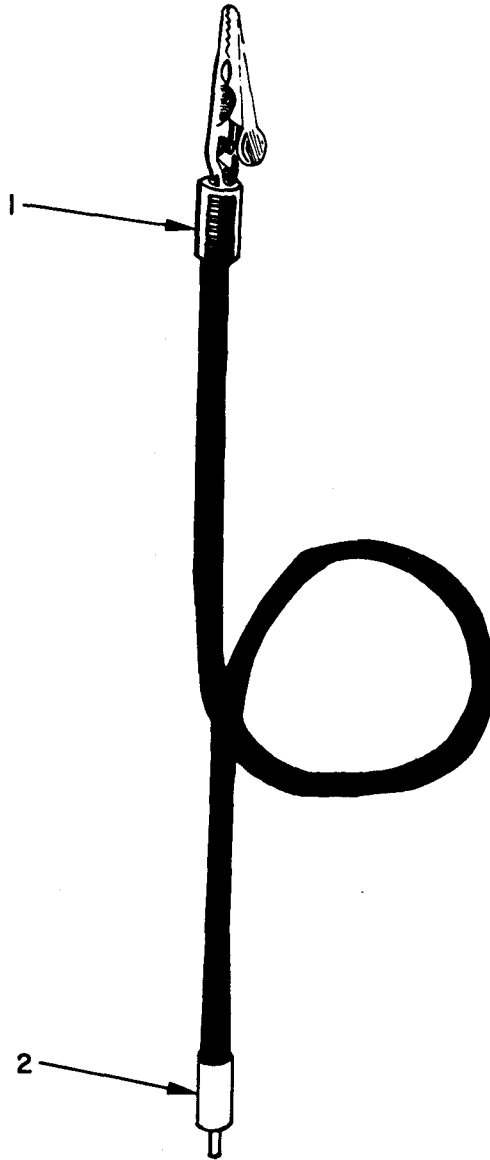

Figure 4. Circuit Card Assembly.

(1) ILLUSTRATION		(2)	(3)	(4)	(5)	(6)	(7)	(8)
(a) FIG NO.	(b) ITEM NO.	SMR CODE	NATIONAL STOCK NUMBER	PART NUMBER	FSCM	DESCRIPTION	USABLE ON CODE	QTY INC IN UNIT
						GROUP 0201 CIRCUIT CARD ASSEMBLY		
4	1	PAFZZ	5905-00-106-1356	RCR07G152JS	81349	RESISTOR, FIXED, COMPOSITION		EA 1
4	2	PAFZZ	5905-00-686-3838	RCO7GF273J	81349	RESISTOR, FIXED, COMPOSITION		EA 2
4	3	PAFZZ	5961-00-892-1009	1N963B	81349	SEMICONDUCTOR DEVICE, DIODE		EA 1
4	4	PAFZZ	5905-00-060-2470	RN60D1004F	81349	RESISTOR, FIXED, FILM		EA 1
4	5	PAFZZ	5905-00-052-2473	RN60D8871F	81349	RESISTOR, FIXED, FILM		EA 1
4	6	PAFZZ	5961-00-787-5305	2N718A	81349	TRANSISTOR		EA 3
4	7	XDFZZ		RCO7GF123K	81349	RESISTOR, FIXED, FILM		EA 1
4	8	PAFZZ	5961-00-577-6084	1N645	81349	SEMICONDUCTOR DEVICE, DIODE		EA 3
4	9	PAFZZ	5905-00-116-8555	RCR07G153JS	81349	RESISTOR, FIXED, COMPOSITION		EA 1
4	10	PAFZZ	5905-00-816-8554	RCO7GF103K	81349	RESISTOR, FIXED, COMPOSITION		EA 1
4	11	PAFZZ	5910-00-113-5689	CS13BE476M	81349	CAPACITOR, FIXED, ELECTROLYTIC		EA 1
4	12	PAFZZ	5905-00-106-1278	RCO7GF821K	81349	RESISTOR, FIXED, COMPOSITION		EA 1
4	13	PAFZZ	5905-00-691-0195	RCO7GF562K	81349	RESISTOR, FIXED, COMPOSITION		EA 1
4	14	PAFZZ	5905-00-687-0000	RCO7GF183J	81349	RESISTOR, FIXED, COMPOSITION		EA 1



EL2VK005

Figure 5. Cable, Power (Red) 785-4933-001.

(1) ILLUSTRATION		(2)	(3)	(4)	(5)	(6)	(7)	(8)
(a) FIG NO	(b) ITEM NO	SMR CODE	NATIONAL STOCK NUMBER	PART NUMBER	FSCM	DESCRIPTION	USABLE ON CODE	QTY INC IN UNIT
5	1	XDOZZ	5999-00-204-8350	25C	76545	GROUP 05 CABLE, POWER(RED)785-4933-001		EA 1
5	2	XDOZZ	5935-00-841-3233	262RED	83330	CLIP, ELECTRICAL PLUG, TIP		EA 1

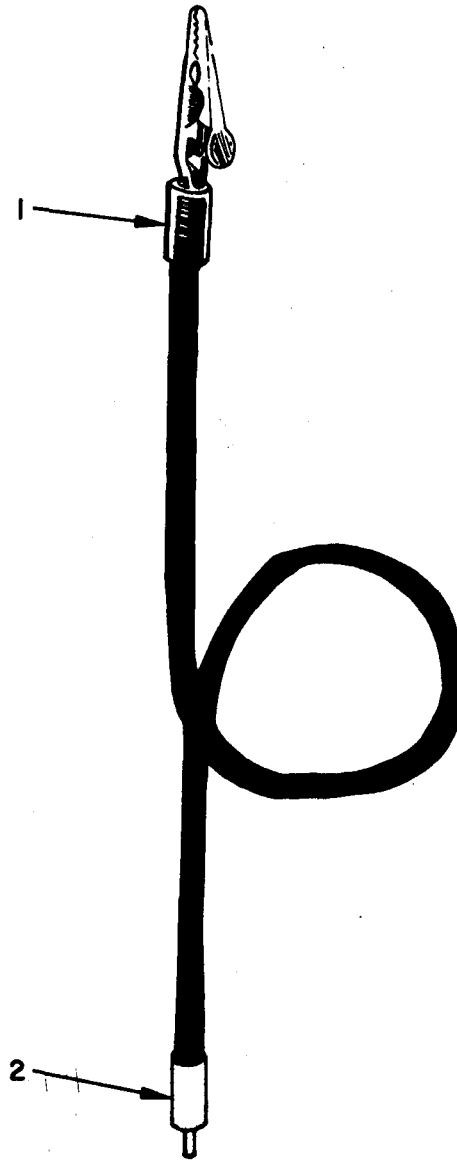

EL2VK006

Figure 6. Cable, Power (Black) 785-4933-002.

(1) ILLUSTRATION		(2)	(3)	(4)	(5)	(6)	(7)	(8)
(a) FIG NO	(b) ITEM NO	SMR CODE	NATIONAL STOCK NUMBER	PART NUMBER	FSCM	DESCRIPTION	USABLE ON CODE	QTY INC IN UNIT
6	1	XDOZZ	5999-00-204-8350	25C	76545	GROUP 06 CABLE, POWER(BLACK)785-4933-002		EA 1
6	2	XDOZZ	5935-00-814-1602	262BLACK	83330	CLIP,ELECTRICAL PLUG,TIP		EA 1

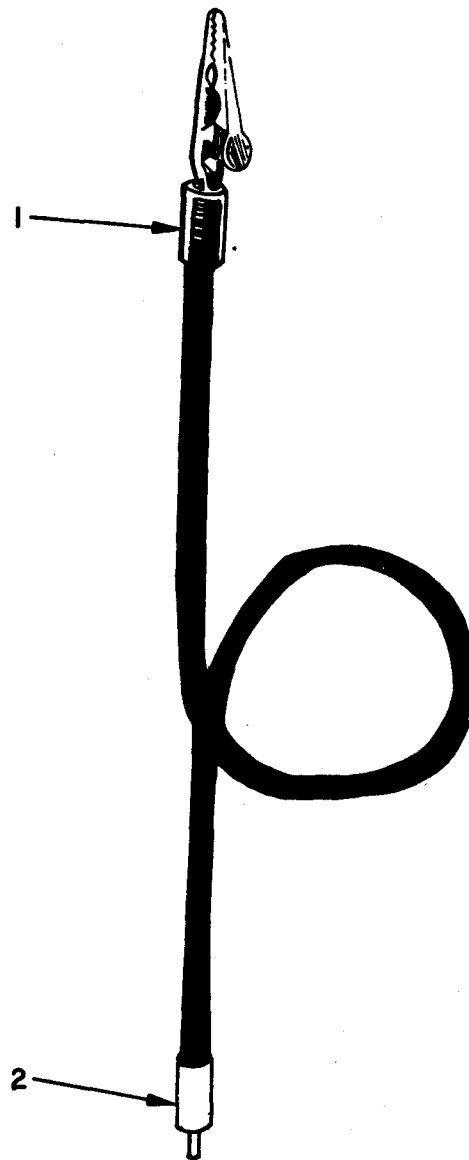

Figure 7. Test Lead (Red) 785-4935-001.

(1) LLUS (a) FIG NO.		(2) TIC (b) FEM	(3) SMR CODE	(3) NATIONAL STOCK NUMBER	(4) PART NUMBER	(5) FSCM	(6) DESCRIPTION USABLE ON CODE	(7) /M	(8) QTY INC IN UNIT
7	1		XD0ZZ		30	76545	GROUP 07 TEST LEAD(RED)785-4935-001		EA 1
7	2		XD0ZZ	9935-00-841-3233	262RED		CLIP, ELECTRICAL PLUG, TIP		EA 1

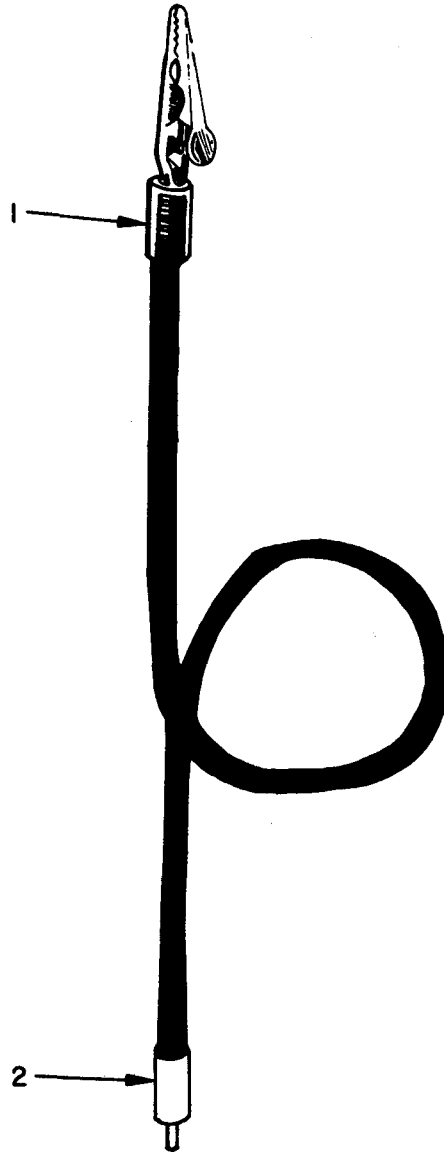

Figure 8. Test Lead (Black) 785-4935-002.

(1) ILLUSTRATION		(2)	(3)	(4)	(5)	(6)	(7)	(8)
(a) FIG NO.	(b) ITEM NO.	SMR CODE	NATIONAL STOCK NUMBER	PART NUMBER	FSCM	DESCRIPTION USABLE ON CODE	U/M	QTY INC IN UNIT
8	1	XDOZZ		30	76545	CLIP, ELECTRICAL	EA	1
8	2	XDOZZ	5935-00-814-1602	262BLACK	83330	GROUP 08 TEST LEAD (BLACK) 785-4935-002 PLUG, TIP	EA	1

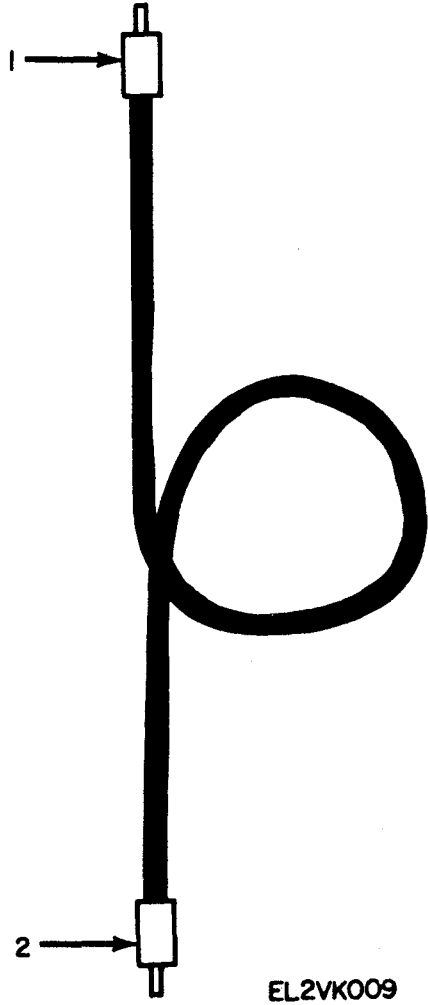

Figure 9. Cable CX-10776/ARM-115.

(1) ILLUSTRATION		(2)	(3)	(4)	(5)	(6)	(7)	(8)
(a) FIG NO	(b) ITEM NO	SMR CODE	NATIONAL STOCK NUMBER	PART NUMBER	FSCM	DESCRIPTION USABLE ON CODE	U/M	QTY INC IN UNIT
						GROUP 09 CABLE CX-10776/ARM-115		
9	1	XDOZZ	5935-00-729-8687	PT06A12-10PSR	77820	CONNECTOR, PLUG, ELECTRICAL	EA	1
9	2	XDOZZ	5935-00-729-8688	PT06A12-10SSR	77820	CONNECTOR, PLUG, ELECTRICAL	EA	1

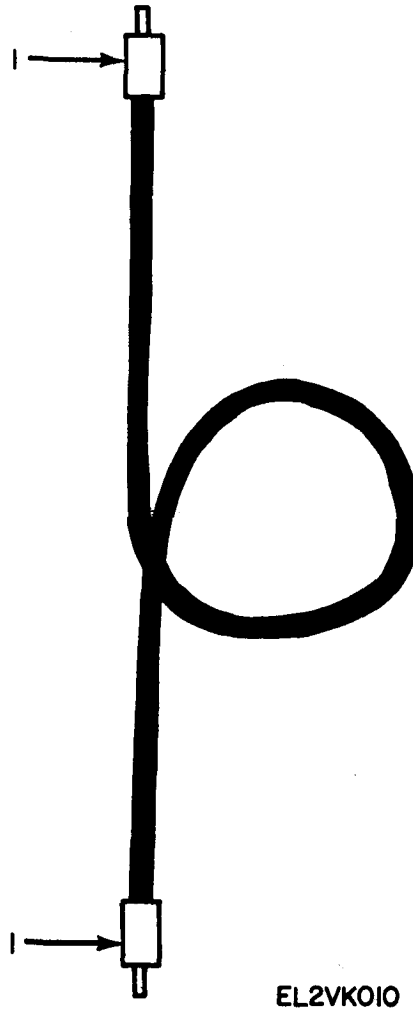

Figure 10. Cable CG1893A/U.

(1) ILLUSTRATION		(2)	(3)	(4)	(5)	(6)	(7)	(8)
(a) FIG NO.	(b) ITEM NO.	SMR CODE	NATIONAL STOCK NUMBER	PART NUMBER	FSCM	DESCRIPTION USABLE ON CODE	11-87	QTY INC IN 1417
10	1	XDOZZ	5935-00-823-0487	UG88EU	80058	GROUP 10 CABLE CG-1893A/U CONNECTOR, PLUG, ELECTRICAL	EA	2

NOTE: LATEST NATIONAL INCLUDED AT END OF INDEX

STOCK NUMBER	FIGURE NO	ITEM NO	STOCK NUMBER	FIGURE NO	ITEM NO
5305-00-050-9228	3	6	6625-00-782-0824	1	4
5905-00-052-2473	4	5	6625-00-782-0835	1	5
5305-00-054-6651	3	2	5961-00-787-5305	4	6
5305-00-054-6653	2	35	5935-00-814-1602	6	2
5905-00-057-8496	3	18	5935-00-814-1602	8	2
5905-00-060-2470	4	4	5905-00-816-8554	4	10
6240-00-080-2012	2	22	5940-00-817-4880	2	8
5905-00-195-5514	4	1	5910-00-822-5683	3	14
5999-00-204-8350	5	1	5935-00-823-0487	3	1
5999-00-204-8350	6	1	5935-00-823-0487	10	1
5355-00-253-4199	2	26	5935-00-826-1020	3	4
5310-00-261-7717	2	33	5935-00-841-3233	5	2
5310-00-269-6291	2	21	5935-00-841-3233	7	2
6625-00-498-2492	3	11	5920-00-855-4260	2	9
5310-00-550-3796	2	36	6625-00-878-4582	1	2
5940-00-577-3695	2	10	5961-00-892-1009	4	3
5961-00-577-6084	4	8	5920-00-892-9311	3	8
5930-00-655-1518	3	22	5935-00-904-4469	2	12
5935-00-682-0501	3	20	5355-00-909-0465	2	30
6210-00-682-9833	3	23	5310-00-924-5968	2	20
5310-00-685-1450	2	3	5310-00-929-6395	3	3
5905-00-687-0000	4	14	5310-00-933-8118	2	25
5905-00-691-0195	4	13	5310-00-933-8120	3	7
5935-00-729-8687	9	1	5995-00-935-2671	1	9
5935-00-729-8688	3	9	6625-00-935-2678	1	10
5935-00-729-8688	9	2	6625-00-935-4296	2	1
5305-00-763-6961	2	24	6625-00-935-4297	1	8
6625-00-782-0367	3	24	6625-00-935-4298	1	7
6625-00-782-0369	3	13	6625-00-935-4903	1	1
6625-00-782-0822	1	6	5935-00-946-2091	2	13
6625-00-782-0823	1	3			

PART NUMBER	FSCM	FIG NO	ITEM NO	PART NUMBER	FSCM	FIG NO	ITEM NO
BNCCC2F3		2	37				
CG1893AU	80058	1	9	RN60D1004F	81349	4	4
C 3AW103M	81349	3	14	RN60D8871F	81349	4	5
C BE476M	81349	4	11	SKM397	74284	2	14
C 3AU	80056	2	7	SKM518	74284	2	16
C 2ARM115	80058	1	1	SKM598	74284	2	15
C 3ARM115	80058	2	1	SKS1789	74284	2	17
CX 776ARM115	80058	1	10	SKS1800	74284	2	5
CY6419ARM115	80058	1	7	TS2642ARM115	80058	1	8
FHN26G	81349	3	8	011-0113-00	24036	2	18
F02B125V2AS	81349	2	9	011-0115-00	24036	2	19
KS22959	71450	3	18	1ASWTE730AJTEO	90484	3	10
MS112E12-105	96906	3	4	1N645	81349	4	8
MS25081-1	96906	2	20	1N963B	81349	4	3
MS25082-8	96906	2	23	1005-3	00471	2	29
MS25256-6	96906	3	23	1718-02	78189	2	36
MS3180-12C	96906	2	13	1720-02	78189	2	33
MS3181-12C	96906	2	12	2N718A	81349	4	6
MS35058-27	81349	3	22	228001K3	76854	3	17
				25C	76545	5	1
				25C	76545	6	1
				2531-5101002SPL	65092	3	13
MS35338-135	96906	2	25	262BLACK	83330	6	2
MS35338-136	96906	3	3	262BLACK	83330	8	2
MS35338-138	96906	3	7	262RED	83330	5	2
MS35367-913A	96906	3	20	262RED	83330	7	2
MS51957-27	96906	3	2	29-1B	81073	2	10
MS51957-29	96906	2	35	29-1R	81073	2	8
MS51957-62	96906	3	6	30	76545	7	1
MS51959-26	96906	2	24	30	76545	8	1
MS51981-26	96906	2	31	310-0049-00	79807	2	3
MS51981-28	96906	2	27	327AS15	71744	2	22
MX8000ARM115	80058	1	2	4152C	70998	3	24
PT06A12-10PSR	77820	9	1	60-31	00471	3	15
PT06A12-10SSR	77820	3	9	68NM62	72962	2	34
PT06A12-10SSR	77820	9	2	729	01016	2	11
P313-0064-00	77250	2	32	757-0228-001	13499	2	30
RC07GF103K	81349	4	10	757-0228-003	13499	2	26
RC07GF123K	81349	4	7	766-7635-002	13499	3	16
				768-3176-004	13499	3	12
RC07GF183J	81349	4	14	774-7389-001	13499	3	11
				78-2BNC	00471	3	21
RC07GF562K	81349	4	13	783-4126-001	13499	2	2
RC07GF821K	81349	4	12	783-4126-002	13499	2	4

PART NUMBER	FSCM	FIG NO	ITEM NO	PART NUMBER	FSCM	FIG NO	ITEM NO
783-4130-001	13499	2	6	785-4935-002	13499	1	6
785-4933-001	13499	1	3	8000-26	00471	2	28
785-4933-002	13499	1	4	8100-18	00471	3	19
785-4935-001	13499	1	5	8947-151	04009	2	21

LATEST NATIONAL STOCK NUMBER ASSIGNMENTS

STOCK NUMBER	FIGURE NO.	ITEM NO.
5905-00-106-1356	4	1
5905-00-116-8555	4	9
5905-00-686-3838	4	2
5940-00-817-4880	2	8
5935-00-850-8876	3	5

LATEST PART NUMBER ASSIGNMENT

PART NUMBER	FSCM	FIG. NO.	ITEM NO.
RC07GF273J	81349	4	2
UG88EU	80058	3	1
UG88EU	80058	10	1
UG909CU	80058	3	5

ADDITIONAL LATEST NATIONAL STOCK NUMBER ASSIGNMENTS

STOCK NUMBER	FIGURE NO.	ITEM NO.
5905-00-106-1278	4	12
5910-00-113-5689	4	11

ADDITIONAL LATEST PART NUMBER ASSIGNMENTS

PART NUMBER	FSCM	FIG. NO.	ITEM NO.
RCR07G152JS	81349	4	1
RCR07G153JS	81349	4	9

RECOMMENDED CHANGES TO EQUIPMENT TECHNICAL MANUALS



SOMETHING WRONG WITH THIS MANUAL?

THEN... JOT DOWN THE DOPE ABOUT IT ON THIS FORM, TEAR IT OUT, FOLD IT AND DROP IT IN THE MAIL!

FROM: (YOUR UNIT'S COMPLETE ADDRESS)
 Commander
 Stateside Army Depot
 ATTN: AMSTA-US
 Stateside, N.J. 07703
 DATE 10 July 1975

PUBLICATION NUMBER: TM 11-5840-340-12
 DATE: 23 Jan 74
 TITLE: Radar Set AN/PSC-76

BE EXACT... PIN-POINT WHERE IT IS				IN THIS SPACE TELL WHAT IS WRONG AND WHAT SHOULD BE DONE ABOUT IT:
PAGE NO.	PARA-GRAPH	FIGURE NO.	TABLE NO.	
2-25	2-28			<p>Recommend that the installation antenna alignment procedure be changed throughout to specify a 2° IFF antenna lag rather than 1°.</p> <p>REASON: Experience has shown that with only a 1° lag, the antenna servo system is too sensitive to wind gusting in excess of 25 knots, and has a tendency to rapidly accelerate and decelerate as it hunts, causing strain to the drive train. Hunting is minimized by adjusting the lag to 2° without degradation of operation.</p>
3-10	3-3		3-1	<p>Item 5, Function column. Change "2 db" to "3db."</p> <p>REASON: The adjustment procedure for the TRANS POWER FAULT indicator calls for a 3 db (500 watts) adjustment to light the TRANS POWER FAULT indicator.</p>
5-6	5-8			<p>Add new step f.1 to read, "Replace cover plate removed in step e.1, above."</p> <p>REASON: To replace the cover plate.</p>
		F03		<p>Zone C 3. On J1-2, change "+24 VDC to "+5 VDC."</p> <p>REASON: This is the output line of the 5 VDC power supply. + 24 VDC is the input voltage.</p>

TEAR ALONG DOTTED LINE

TYPED NAME, GRADE OR TITLE, AND TELEPHONE NUMBER
 SSG I. M. DeSpirito 999-1776

SIGN HERE:
SSG I. M. DeSpirito

DA FORM 2028-2
 1 AUG 74

...IF YOUR OUTFIT WANTS TO KNOW ABOUT YOUR MANUAL "FIND," MAKE A CARBON COPY OF THIS AND GIVE IT TO YOUR HEADQUARTERS.

HISA 1686-75

RECOMMENDED CHANGES TO EQUIPMENT TECHNICAL MANUALS



SOMETHING WRONG WITH THIS MANUAL?

THEN...JOT DOWN THE DOPE ABOUT IT ON THIS FORM, TEAR IT OUT, FOLD IT AND DROP IT IN THE MAIL!

FROM: (YOUR UNIT'S COMPLETE ADDRESS)

DATE

PUBLICATION NUMBER

TM 11-6625-1702-24P

DATE

1 NOV 78

TITLE

Test Set, Antenna AN/ARM-115

BE EXACT...PIN-POINT WHERE IT IS

IN THIS SPACE TELL WHAT IS WRONG AND WHAT SHOULD BE DONE ABOUT IT:

PAGE NO.

PARA-GRAPH

FIGURE NO.

TABLE NO.

TEAR ALONG DOTTED LINE

TYPED NAME, GRADE OR TITLE, AND TELEPHONE NUMBER

SIGN HERE:

DA FORM 2028-2
1 AUG 74

P.S.--IF YOUR OUTFIT WANTS TO KNOW ABOUT YOUR MANUAL "FIND" MAKE A CARBON COPY OF THIS AND GIVE IT TO YOUR HEADQUARTERS.

FILL IN YOUR
UNIT'S ADDRESS

FOLD BACK

DEPARTMENT OF THE ARMY

OFFICIAL BUSINESS
PENALTY FOR PRIVATE USE, \$300

Commander
US Army Communications and
Electronics Materiel Readiness Command
ATTN: DRSEL-ME-MQ
Fort Monmouth, New Jersey 07703

FOLD BACK

TEAR ALONG DOTTED LINE

RECOMMENDED CHANGES TO EQUIPMENT TECHNICAL MANUALS



THEN... JOT DOWN THE DOPE ABOUT IT ON THIS FORM, TEAR IT OUT, FOLD IT AND DROP IT IN THE MAIL!

SOMETHING WRONG WITH THIS MANUAL?

FROM: (YOUR UNIT'S COMPLETE ADDRESS)

DATE

PUBLICATION NUMBER

TM 11-6625-1702-24P

DATE

1 NOV 78

TITLE

Test Set, Antenna AN/ARM-115

BE EXACT... PIN-POINT WHERE IT IS

IN THIS SPACE TELL WHAT IS WRONG AND WHAT SHOULD BE DONE ABOUT IT:

PAGE NO.	PARA-GRAPH	FIGURE NO.	TABLE NO.
----------	------------	------------	-----------

TEAR ALONG DOTTED LINE

TYPED NAME, GRADE OR TITLE, AND TELEPHONE NUMBER

SIGN HERE:

DA FORM 2028-2
1 AUG 74

P.S.--IF YOUR OUTFIT WANTS TO KNOW ABOUT YOUR MANUAL "FIND," MAKE A CARBON COPY OF THIS AND GIVE IT TO YOUR HEADQUARTERS.

FILL IN YOUR
UNIT'S ADDRESS

FOLD BACK

DEPARTMENT OF THE ARMY

OFFICIAL BUSINESS

PENALTY FOR PRIVATE USE, \$300

Commander
US Army Communications and
Electronics Materiel Readiness Command
ATTN: DRSEL-ME-MQ
Fort Monmouth, New Jersey 07703

FOLD BACK

TEAR ALONG DOTTED LINE

REVERSE OF DA FORM 2026-2

RECOMMENDED CHANGES TO EQUIPMENT TECHNICAL MANUALS



THEN... JOT DOWN THE DOPE ABOUT IT ON THIS FORM, TEAR IT OUT, FOLD IT AND DROP IT IN THE MAIL!

SOMETHING WRONG WITH THIS MANUAL?

FROM: (YOUR UNIT'S COMPLETE ADDRESS)

DATE

PUBLICATION NUMBER

TM 11-6625-1702-24P

DATE

1 Nov 78

TITLE

Test Set, Antenna AN/ARM-115

BE EXACT... PIN-POINT WHERE IT IS

IN THIS SPACE TELL WHAT IS WRONG AND WHAT SHOULD BE DONE ABOUT IT:

PAGE NO.	PARA-GRAPH	FIGURE NO.	TABLE NO.
----------	------------	------------	-----------

TEAM LEADER DOTTED LINE

TYPED NAME, GRADE OR TITLE, AND TELEPHONE NUMBER

SIGN HERE:

DA FORM 2028-2
1 AUG 74

P.S.--IF YOUR OUTFIT WANTS TO KNOW ABOUT YOUR MANUAL "FIND," MAKE A CARBON COPY OF THIS AND GIVE IT TO YOUR HEADQUARTERS.

FILL IN YOUR
UNIT'S ADDRESS

FOLD BACK

DEPARTMENT OF THE ARMY

OFFICIAL BUSINESS

PENALTY FOR PRIVATE USE, \$300

Commander
US Army Communications and
Electronics Materiel Readiness Command
ATTN: DRSEL-ME-MQ
Fort Monmouth, New Jersey 07703

FOLD BACK

TEAR ALONG DOTTED LINE

REVERSE OF DA FORM 2028-2

By Order of the Secretary of the Army:

BERNARD W. ROGERS
General, United States Army
Chief of Staff

Official:

J. C. PENNINGTON
Brigadier General, United States Army
The Adjutant General

DISTRIBUTION:

To be distributed in accordance with DA Form 12-36A, Section II, Organizational Maintenance requirements. for AN/ARM-115.

★ U. S. GOVERNMENT PRINTING OFFICE : 1994 0 - 300-421 (83114)

